



MOBILE SUIT RX-0 UNICORN GUNDAM "Ver.Ka"

©創通・サンライズ ©SOTSU・SUNRISE

対象年齢15才以上 Ages 15 and up

取扱説明書 Instruction manual



SPECIFICATION / MODEL NUMBER:RX-0 HEIGHT:19.7-21.7m WEIGHT:23.7t MATERIAL:GUNDARIUM ALLOY
ARMAMENTS /VULCANGUN X 2 BEAM MAGNUM X 1 HYPER BAZZOKA X1 BEAM SABER X 4 SHIELD X1
CONSTRUCTOR:ANAHEIM ELECTRONICS

BANDAI SPIRITS 2024 MADE IN JAPAN

「MG 1/100 ナラティブガンダム Ver.Ka」付属のクリアピンクサイコフレーム (Cパーツ) を 「MG 1/100 ユニコーンガンダム Ver.Ka」(別売り) に組み込む場合

When installing the Clear Pink Psycho-Frame (C Parts) included in MG 1/100 NARRATIVE GUNDAM Ver.Ka onto the MG 1/100 UNICORN GUNDAM Ver.Ka (sold separately)

- ※未組み立てのMG 1/100 ユニコーンガンダム Ver.Ka (別売り) が1体必要です。
- ※変形はMG 1/100 ユニコーンガンダム Ver.Ka (別売り) の取扱説明書をご覧ください。
- * One un-assembled MG 1/100 UNICORN GUNDAM Ver.Ka (sold separately) is required.
- * See instructions for the MG 1/100 UNICORN GUNDAM Ver.Ka (sold separately) for transformation.

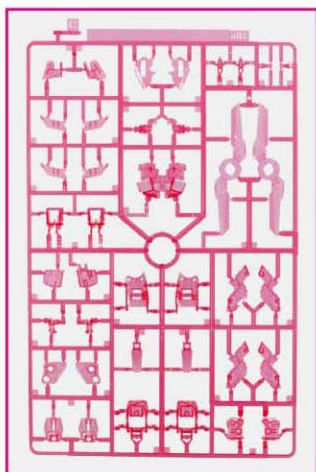

新ディテールサイコフレーム (Cパーツ)
Psycho-Frame parts with new details (C Parts)



MG 1/100 ユニコーンガンダム Ver.Ka (別売り)
MG 1/100 Unicorn Gundam Ver.Ka (sold separately)

- ※画像の完成品は塗装してあります。
- ※画像はイメージです。
- * The completed product in the image has been painted.
- * The images are for illustrative purposes only.



MG 1/100 ナラティブガンダムC装備 Ver.Ka
MG 1/100 NARRATIVE GUNDAM C-PACKS Ver.Ka



MG 1/100 ユニコーンガンダム Ver.Ka
MG 1/100 UNICORN GUNDAM Ver.Ka

シールドのサイコフレームに幾何学模様のディテールが確認できる。太腿に入るサイコフレームをランナー状態で比較すると、MGナラティブガンダムC装備Ver.Kaでは彫刻により厚みが変わり、ディテールの一部分はピンクの濃度が薄くなっているのがわかる。Geometric details can be seen on Psycho-Frame of the shield. Comparing the Psycho-Frame in the thigh when in the runner state, it can be seen that in MG NARRATIVE GUNDAM C-PACKS Ver.Ka, the thickness changes by sculpture and some of the details have a lighter pink density.

注意

お買い上げのお客様へ 必ずお読みください。

- 本商品の対象年齢は15才以上です。対象年齢未満のお子様には絶対に与えないでください。
- 小さな部品がありますので、小さなお子様が誤って飲み込まないように注意してください。窒息などの危険があります。
- 袋を頭からかぶったり、顔を覆ったりしないでください。窒息する恐れがあります。
- 尖った部分や鋭い部分がありますので、取り扱いや保管場所に注意してください。思わぬケガをする恐れがあります。

〈組み立てる時の注意〉

- 組み立てる前に説明書をよく読みましょう。
 - 部品は番号を確かめ、ニッパーなどできれいに切り取りましょう。
 - 部品の加工の際の刃物、工具、塗料、接着剤などのご使用にあたっては、それぞれの取扱説明書をよく読んで正しく使用してください。
 - 塗装には、より安全な水性塗料のご使用をおすすめします。
 - ABS部分への塗装は破損する恐れがありますので、塗装はおすすめできません。
 - 尖った先端や薄い線端部に触れながらの組み立てには十分ご注意ください。
- ※この商品には道具類は入っていませんので、別にご用意ください。

CAUTION

Read the following instructions before use.

- This product is for ages 15 and up. Not suitable for children under this age.
- This product contains small parts. Keep away from small children. Accidentally swallowing small parts may cause choking.
- To avoid suffocation, do not put plastic bags over your face.
- Pay attention to sharp parts and edges. Handle and store them with care to avoid injury.

〈Notes on assembly〉

- Carefully read the instructions before assembling.
 - Check the part numbers, and cut them cleanly with nippers.
 - Carefully read the user manuals about how to handle all sharp-edged tools, paints, adhesives, etc. used in assembly, and use them correctly.
 - Use of water-based paint is recommended for safety reasons.
 - Painting ABS plastic parts is not recommended, as paint can damage the plastic.
 - Pay extra attention when handling sharp points and edges.
- * Tools are not included.

パーツリスト Parts List

※余ったパーツはお好みで自由にお使いください。
* Use the extra parts freely.

Aパーツ (ABS)
A Parts

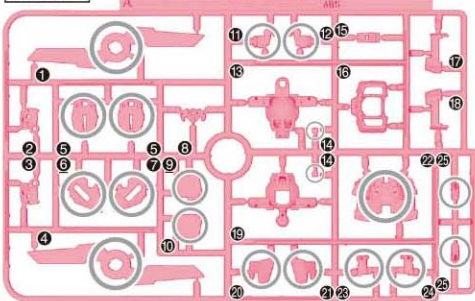

Bパーツ (ABS)
B Parts

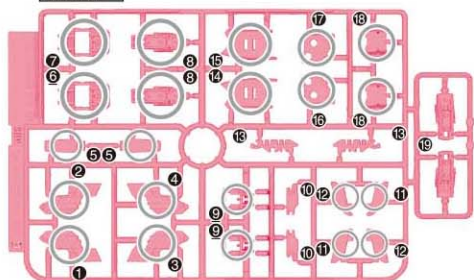

※○印のパーツを、新ディテールサイコフレームパーツ(Cパーツ)に置き替えて組み立てます。
* Replace the parts marked as "○" with the new detail Psycho-Frame parts (C Parts) and assemble.

Cパーツ (PS)
C Parts

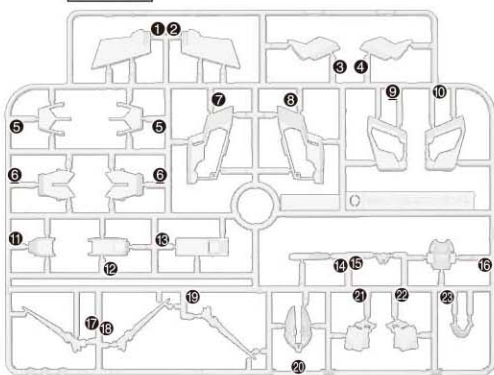

Dパーツ (PS)
D Parts

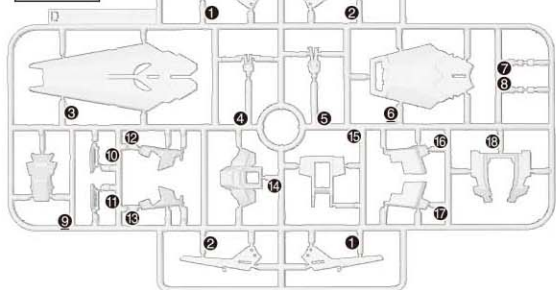

Eパーツ (PS)
E Parts (×2)

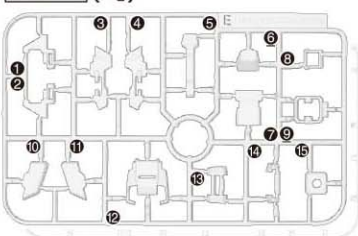

Fパーツ (PS)
F Parts (×2)

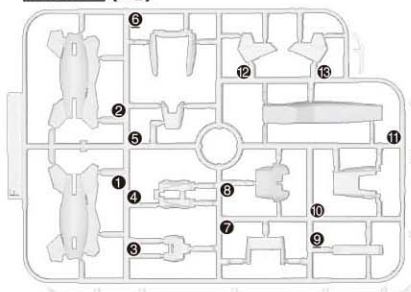

Gパーツ (PS)
G Parts

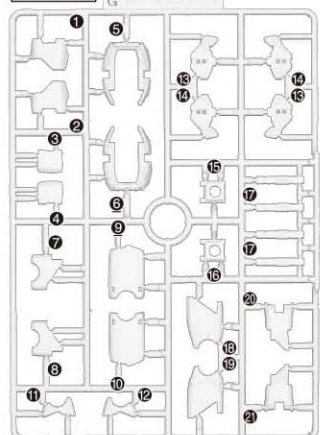

Hパーツ (ABS)
H Parts

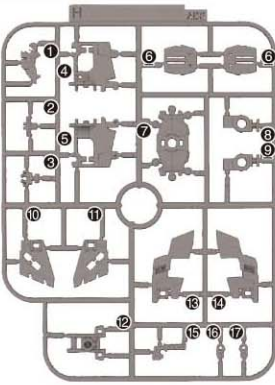

Iパーツ (ABS)
I Parts

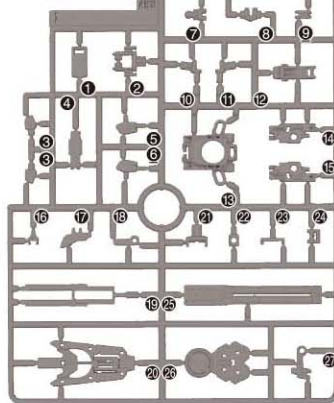

Jパーツ (ABS)
J Parts

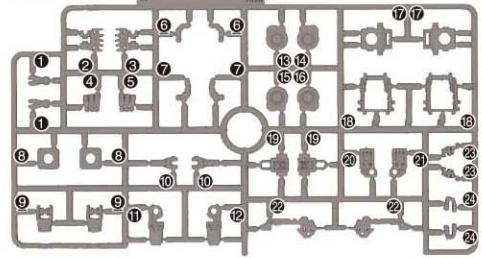

Kパーツ (ABS)
K Parts

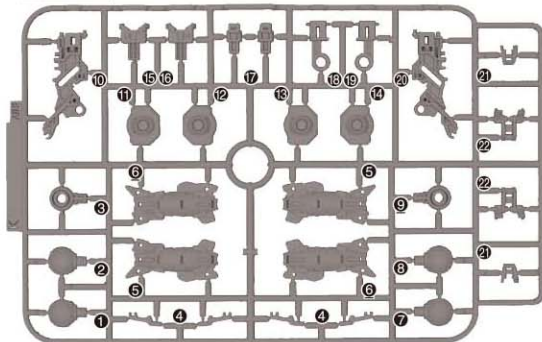

Lパーツ (ABS)
L Parts

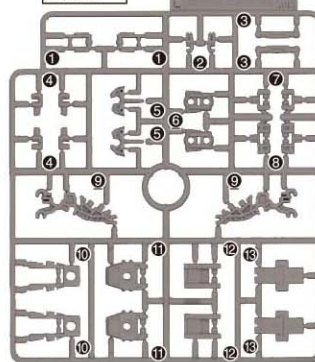

Mパーツ (PS)
M Parts

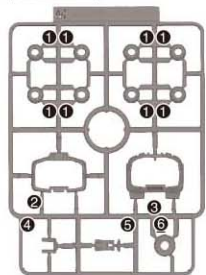

Nパーツ (PS)
N Parts

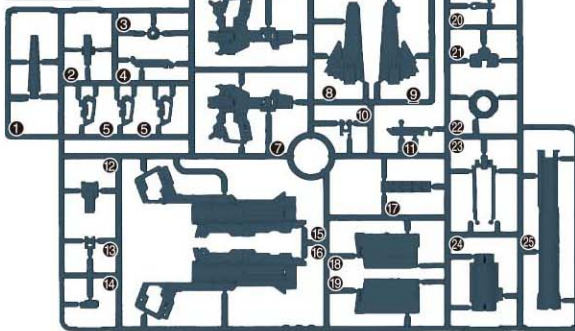

Oパーツ (PS)
O Parts (x2)

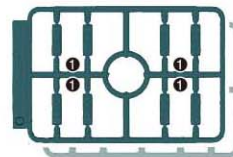

MG 1/100 ナラティブガンダム C装備 Ver.Kalに付属のCパーツ
C parts included in MG 1/100 NARRATIVE GUNDAM C-PACKS Ver.Ka

Cパーツ (ABS)
C Parts

アンダーゲートあり
WITH UNDER GATE

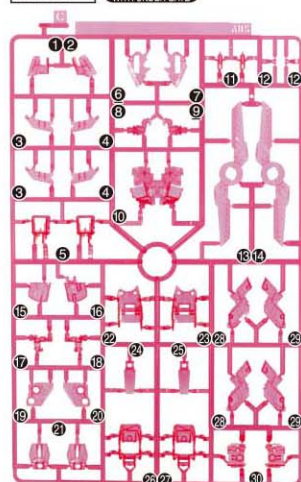

Pパーツ (PS)
P Parts

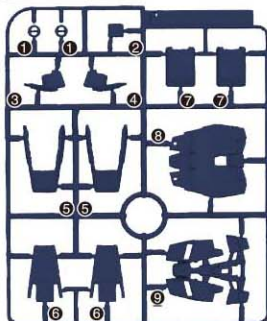

SB1パーツ (PS)
SB1 Parts



シール
Stickers



MG 1/100 ナラティブガンダム C装備 Ver.Kaに付属するCパーツの組み込みかた

How to assemble the C-parts included in MG 1/100 NARRATIVE GUNDAM C-PACKS Ver.Ka

Cパーツ (ABS)
C Parts (ABS)
アンダーゲートあり
WITH UNDER GATE

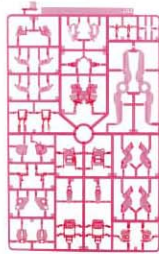

(ナラティブガンダム C装備)
(NARRATIVE GUNDAM C-PACKS)

C1

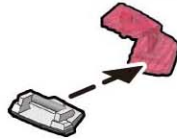

説明中の **C1** で表記されている部品番号は
MG 1/100 ナラティブガンダム C装備
Ver.Kaに付属のCパーツです。

The part numbers marked with **C1** in the
instructions are the C parts included in
MG 1/100 NARRATIVE GUNDAM C-PACKS
Ver.Ka.

組み立て説明図用アイコン Symbols for assembly instruction manuals

1 • 1 → 2 → 3 の順番で組み立てる • Follow the numerical order 1 → 2 → 3 ...	! • 向きに注意して組み立てる • Pay attention to part orientation when assembling.	x2 • 部品を数値の個数作る • Build specified number of parts.	ア • シールの番号 • Sticker number
90° • 数値に合わせて回転させる • Rotate as indicated.	● • 先に組み立てる • Assemble this part first.	● • 後から組み立てる • Assemble this part later.	← → • 反対側も同じように動かす • Move the opposite side as well.
← → • 反対側に取り付けるパーツ • Attach to the opposite side.	● • 選択します。 • Choose one.	✗ • 切り取り注意 • Do not cut.	✂ • 切り取るところ • Cut here.
	● • ビスの締めすぎに注意する • Do not overtighten screws.	● • 接着をするところ • Apply glue here.	

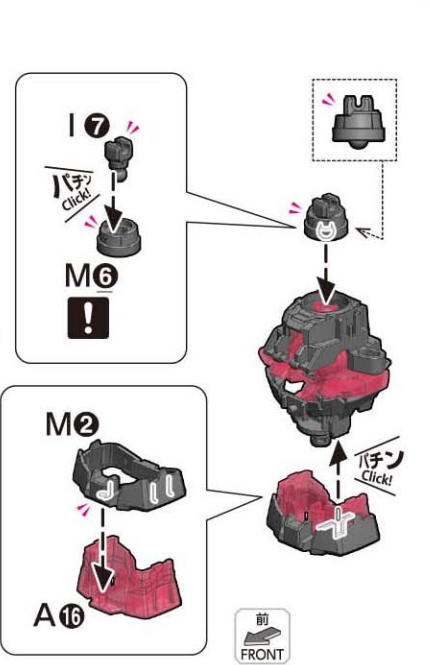
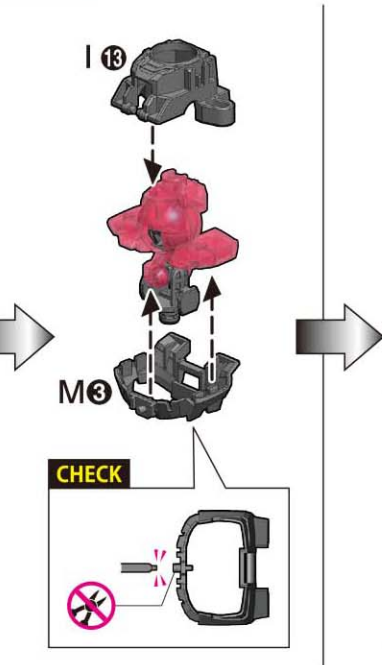
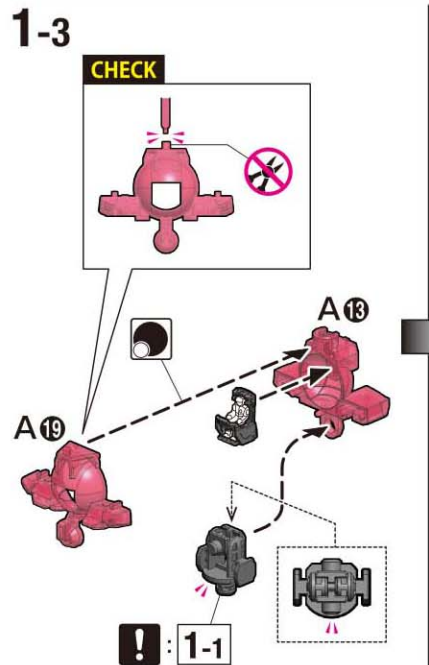
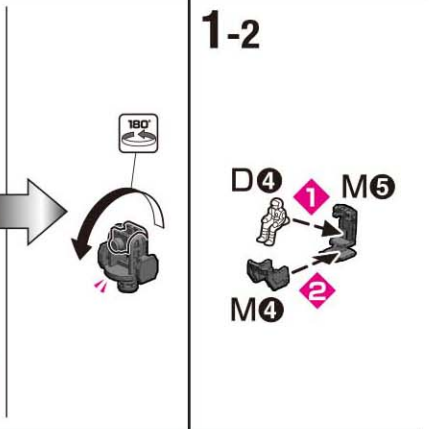
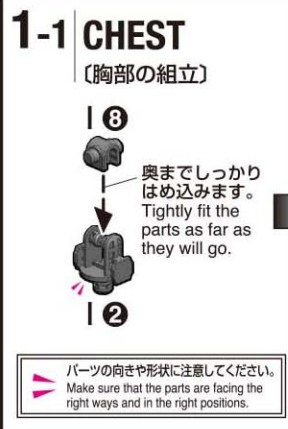
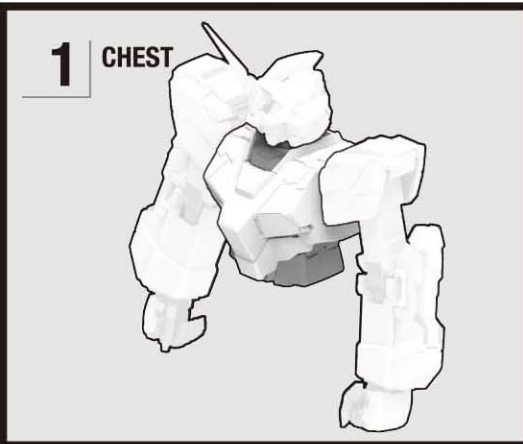

1-4

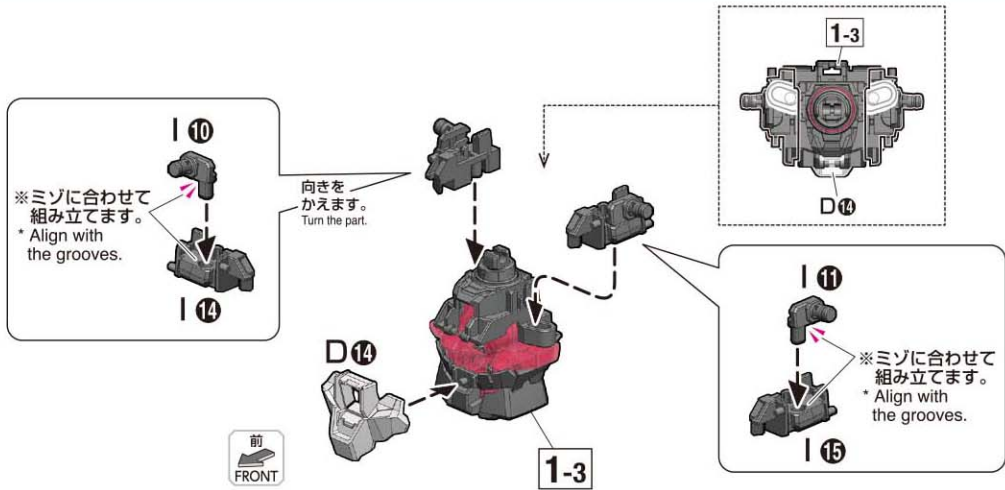

1-5

MG 1/100 ナラティブガンダム C装備
Ver.Kaに付属のCパーツです。
C parts included in MG 1/100 NARRATIVE
GUNDAM C-PACKS Ver.Ka.

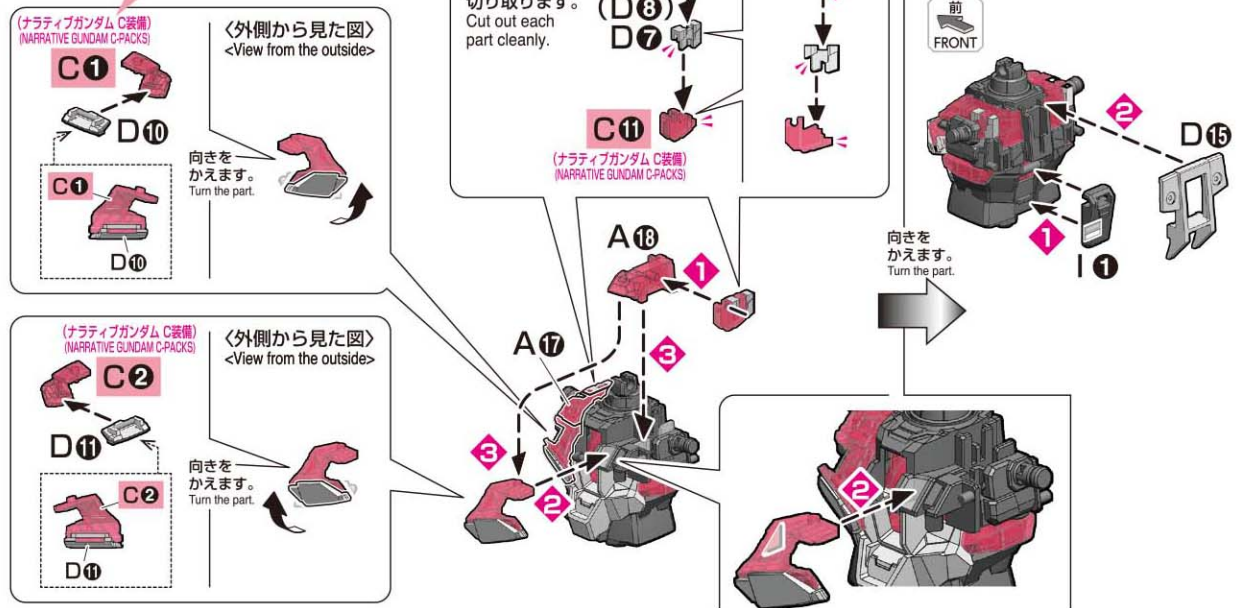

1-6 COMPLETION

(胸部の完成)

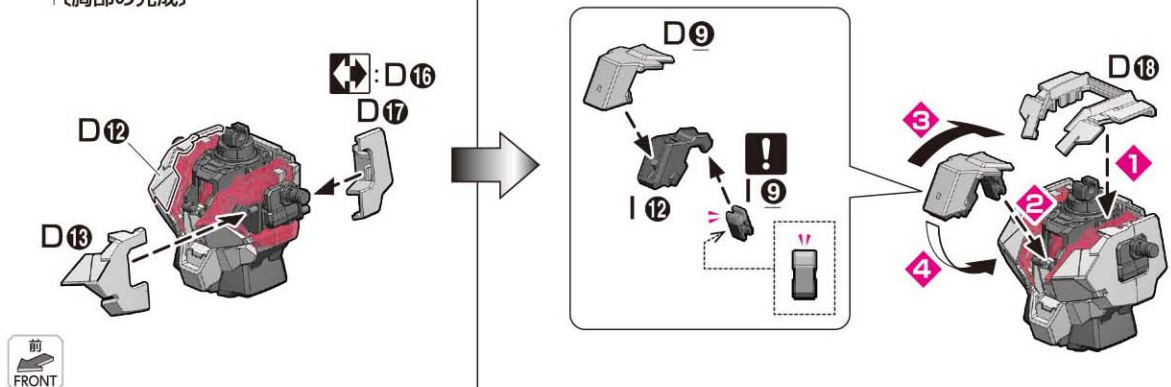

2 HEAD

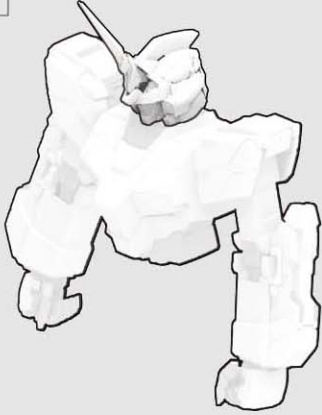

2-1 HEAD

〔頭部の組立〕

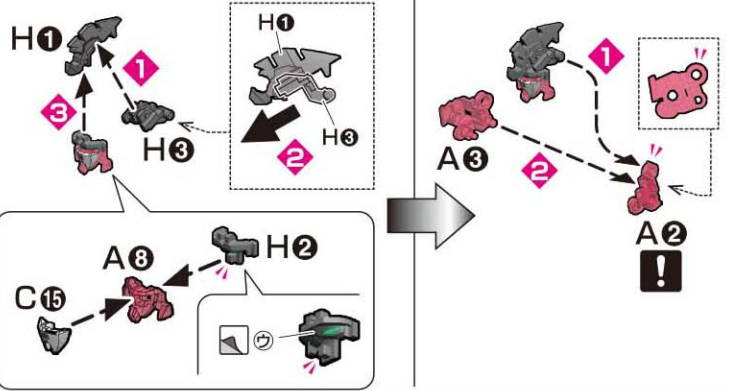

2-2

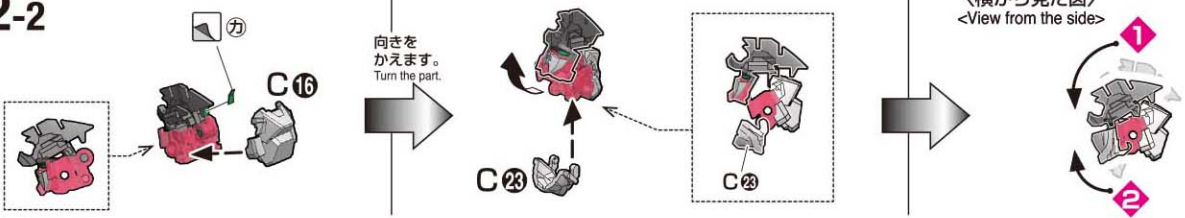

2-3 COMPLETION

〔頭部の完成〕

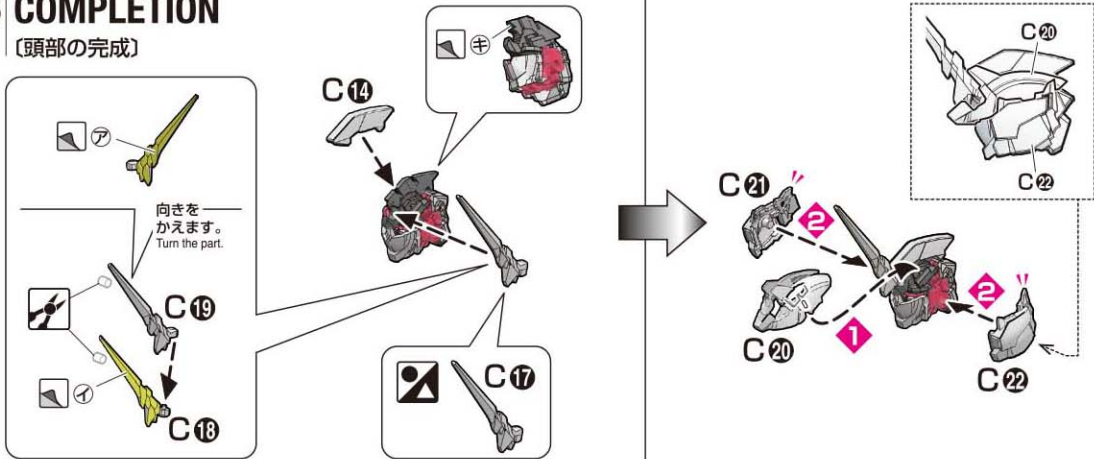

3 RIGHT ARM

4 LEFT ARM

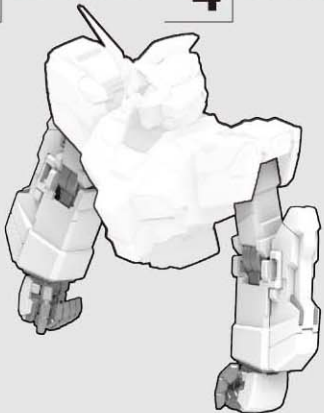

3-1 RIGHT ARM

〔右腕の組立〕

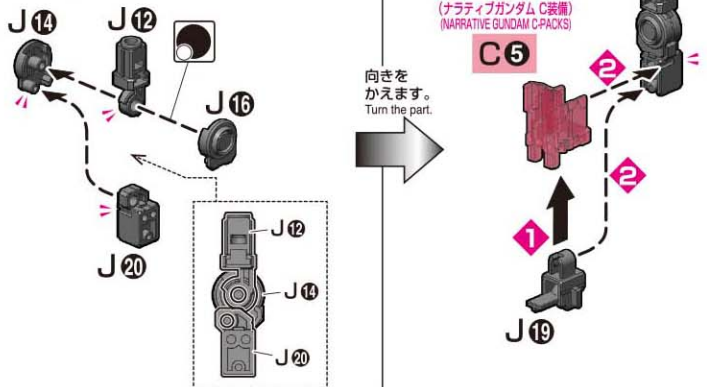

3-2

CHECK

E5 J22 B10

3-1

G15
E9
E6

E4 E3 E2 E1

向きをかえます。
Turn the part.

3-3 COMPLETION

(右腕の完成)

E7
E6

向きをかえます。
Turn the part.

J9 J10 E15

奥までしっかりはめ込みます。
Tightly fit the parts as far as they will go.

J8

外側 Outside 内側 Inside

小さい方 The smaller side 大きい方 The bigger part

向きをかえます。
Turn the part.

J3 J1 G3 J5 J6 J7

向きをかえます。
Turn the part.

G17

4-1 LEFT ARM

(左腕の組立)

J11 J13 J15 J18 J21 J4

向きをかえます。
Turn the part.

(ナラティブガンダム C装備)
(NARRATIVE GUNDAM C-PACKS)

C5

J19

4-2

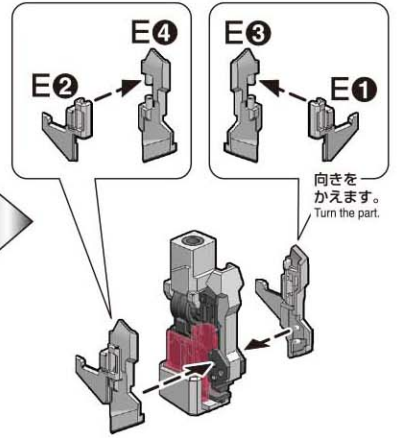
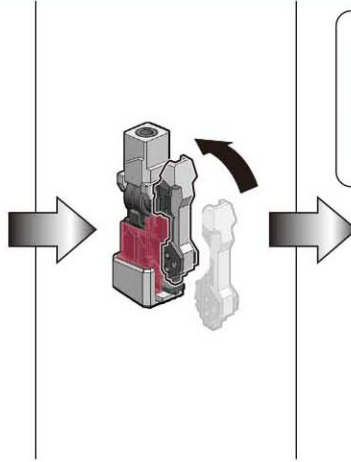
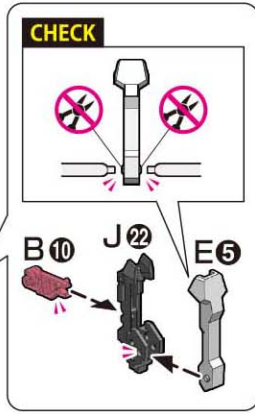
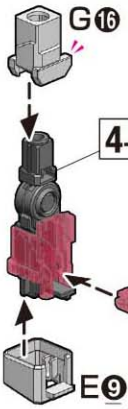

4-3 COMPLETION

(左腕の完成)

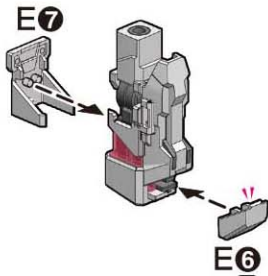

向きをかえます。
Turn the part.

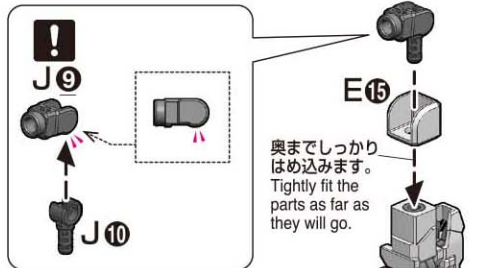

向きをかえます。
Turn the part.

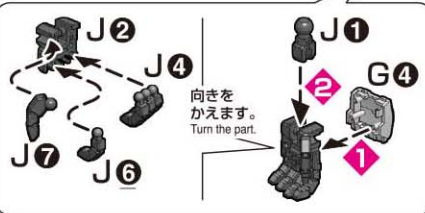
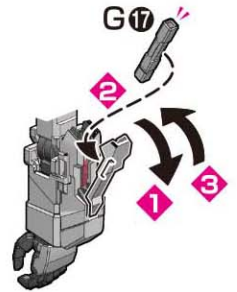

5 UPPER BODY



5-1 UPPER BODY

(上半身の組立)

×2

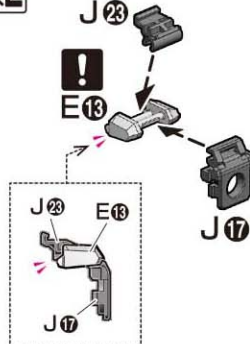

きれいに切り取ります。
Cut out cleanly.

E12



奥までしっかりはめ込みます。
Tightly fit the parts as far as they will go.

〈横から見た図〉
〈View from the side〉



5-2

(ナラティブガンダム C装備)
(NARRATIVE GUNDAM C-PACKS)

×2

C3
(ナラティブガンダム C装備)
(NARRATIVE GUNDAM C-PACKS)

J18

C4

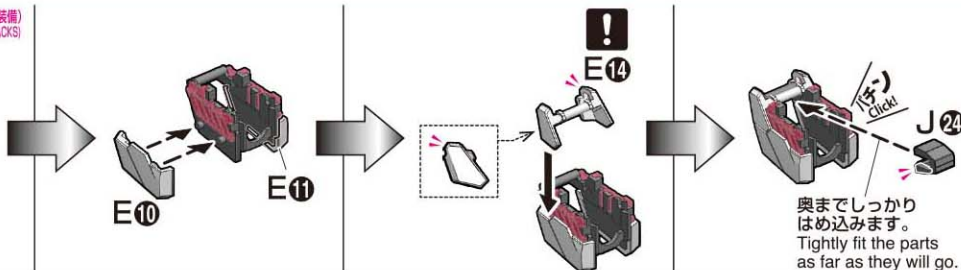

5-3

×2

5-1

E8

1

2

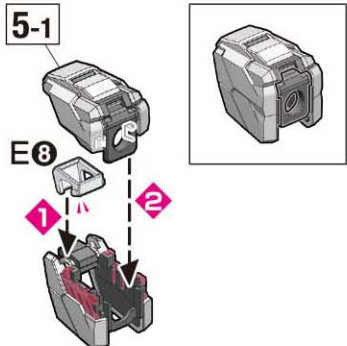

5-4 COMPLETION

〔上半身の完成〕

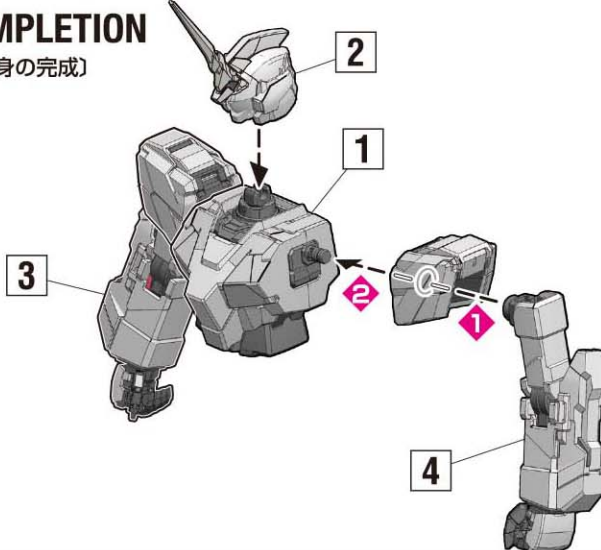

6 WAIST

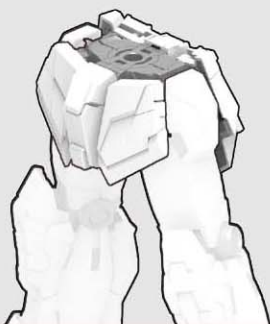

6-1 WAIST

〔腰の組立〕

H4

H8

1/2 Click!

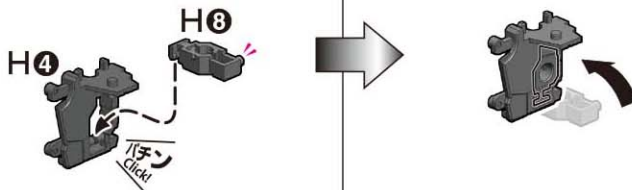

6-2

向きをかえます。
Turn the part.

(ナラティブガンダム C装備)
(NARRATIVE GUNDAM C-PACKS)

C15・C16

H15

H16



C11

前
FRONT

C12

向きをかえます。
Turn the part.

H7

H12

C13

前
FRONT

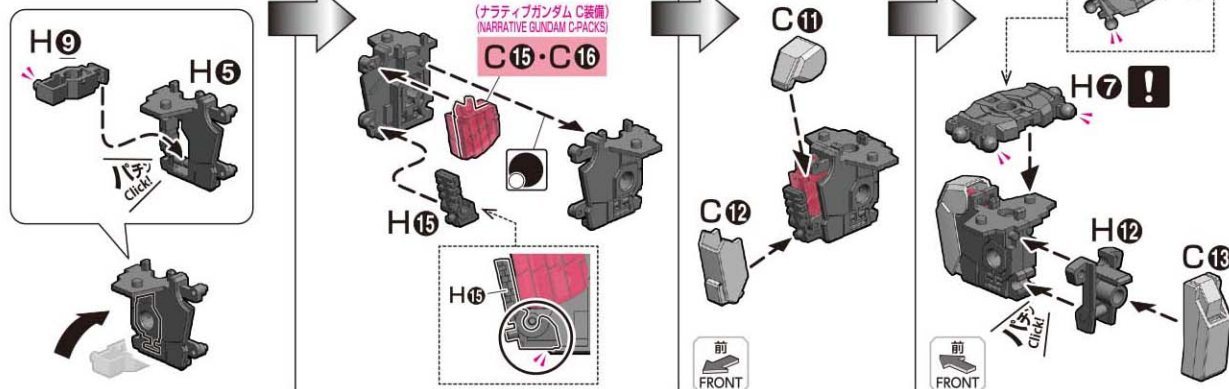

6-3

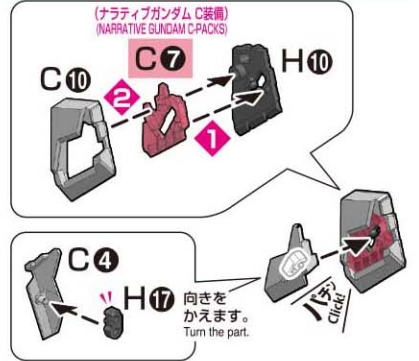
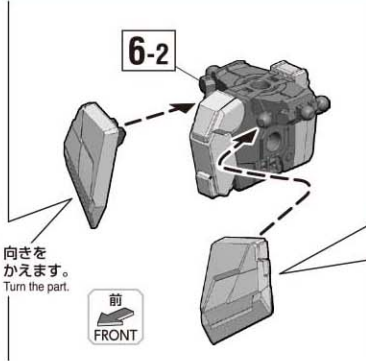
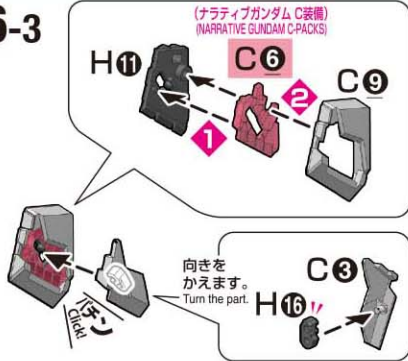

6-4 COMPLETION

(腰の完成)

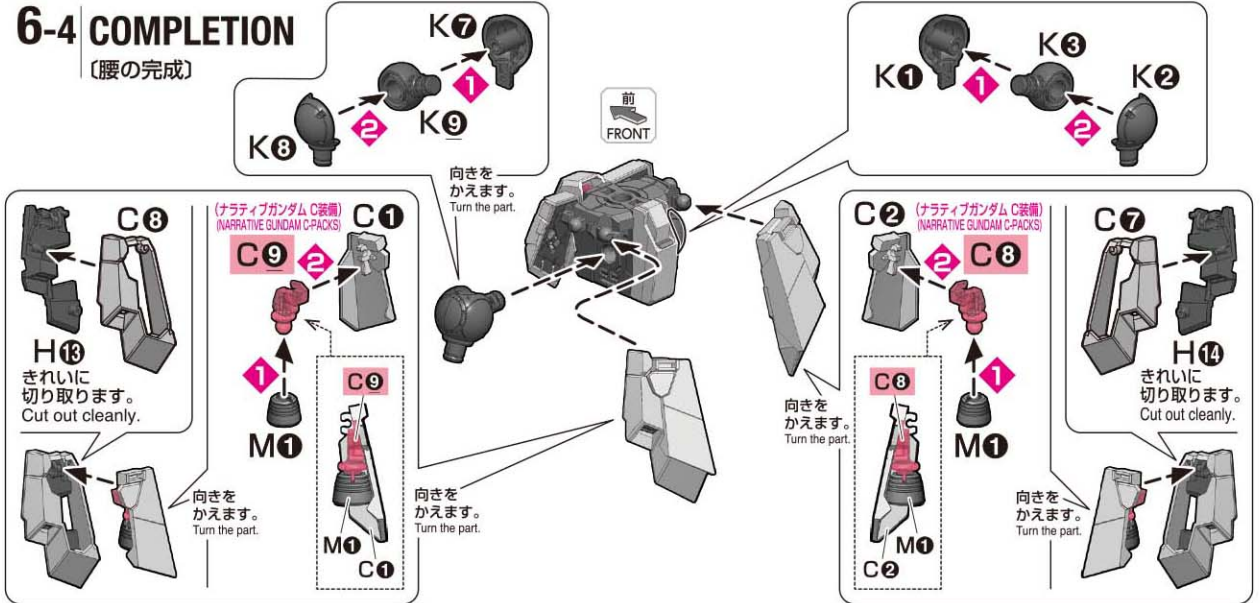

7 RIGHT LEG

8 LEFT LEG

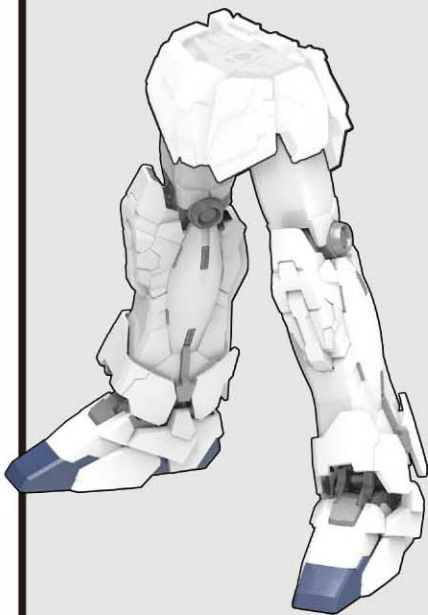

7-1 ANKLE

(足首の組立)

x2

アンダーゲートの切り取りかた Trimming under-gate material

※ **アンダーゲート**と表記されているパーツには裏側にゲートがあります。▶の印が付いている部分は忘れないようにきれいに切り取ってください。
 * Parts designated **UNDER GATE** have excess runner on their inner or back sides. Make sure to trim the portions indicated by the ▶ arrow.

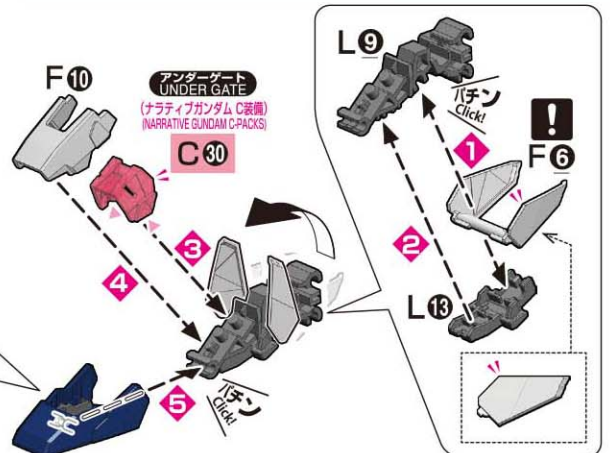
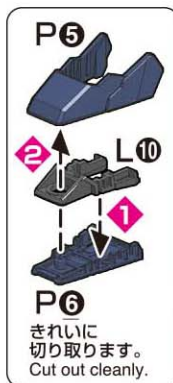
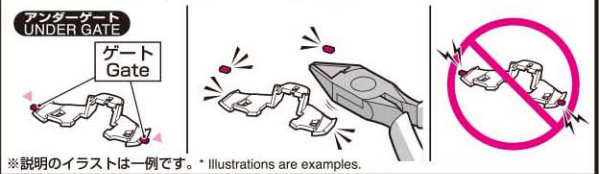

7-2

x2

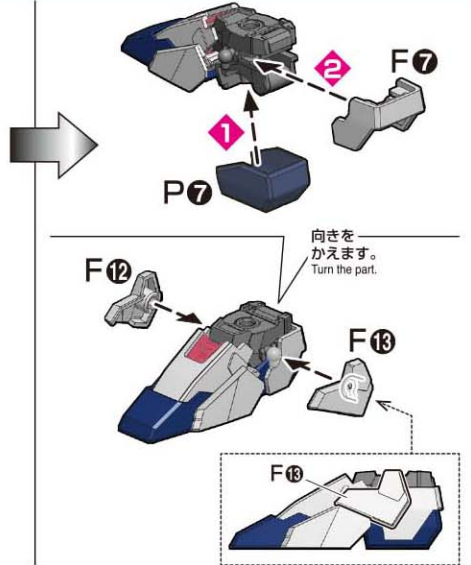
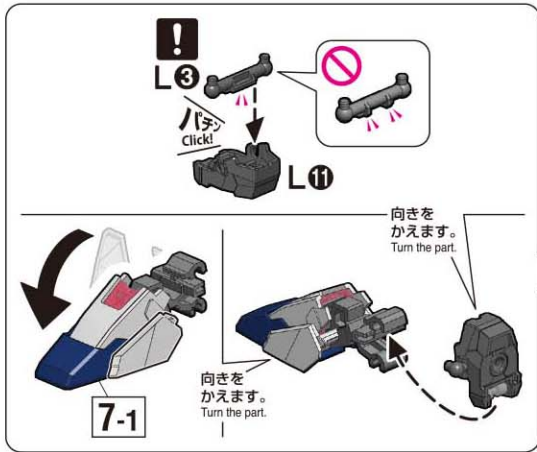

7-3 COMPLETION

(足首の完成)

x2

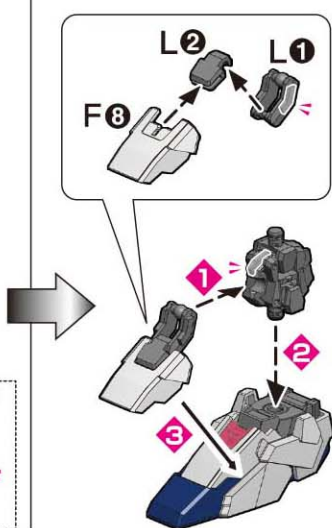
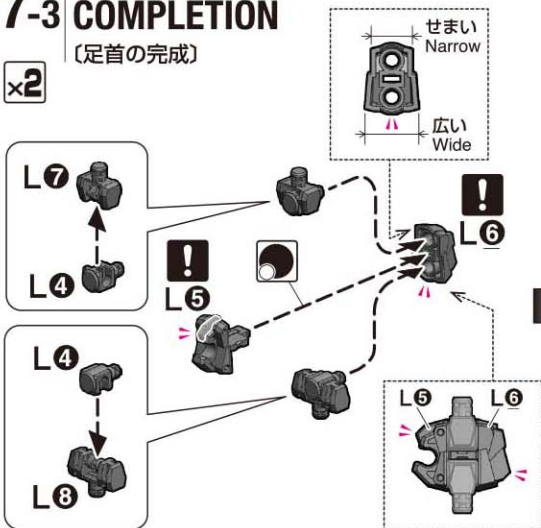

7-4

x2

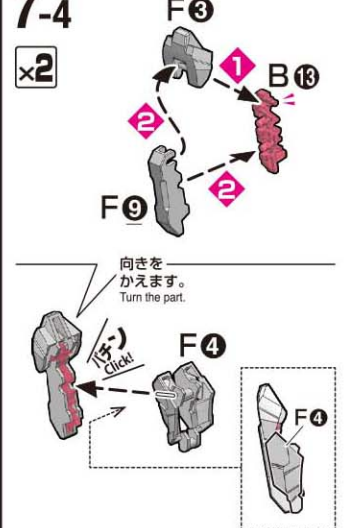

7-5 RIGHT LEG

(右脚の組立)

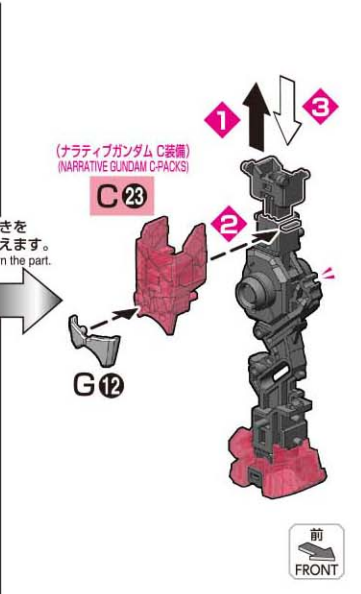
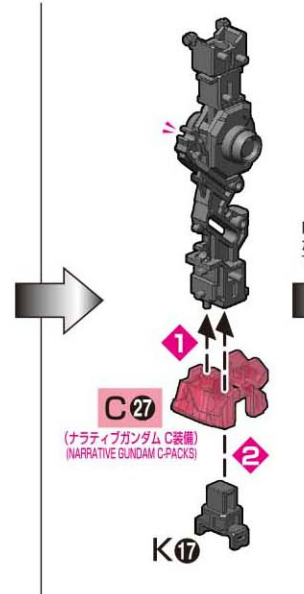
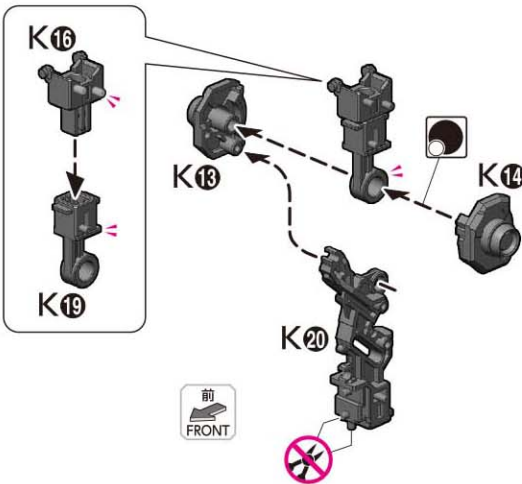

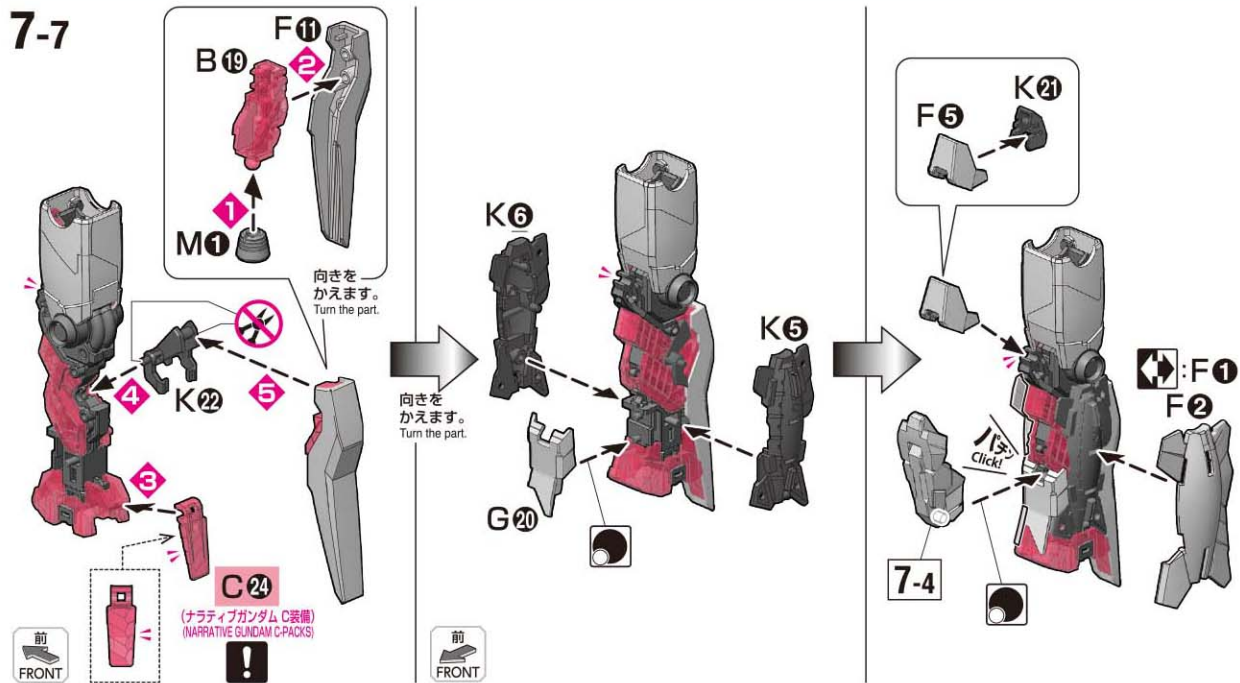
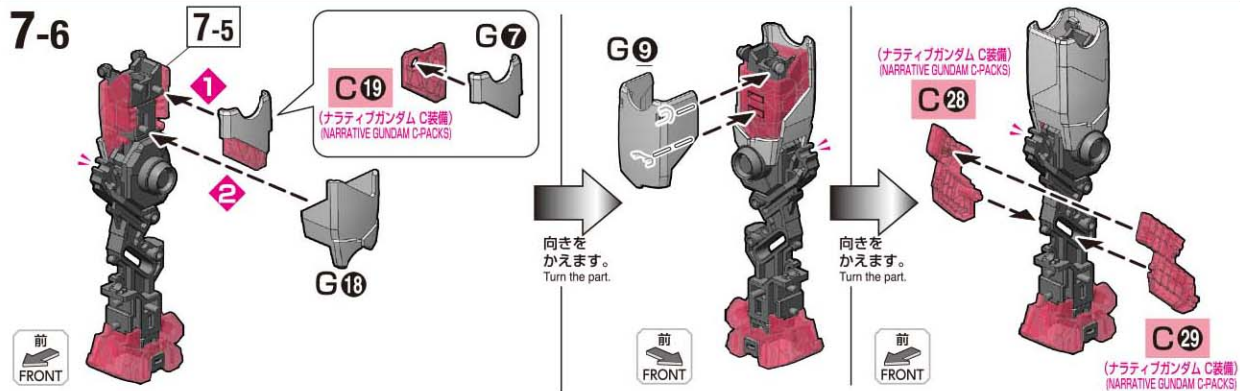

7-8 COMPLETION

(右脚の完成)

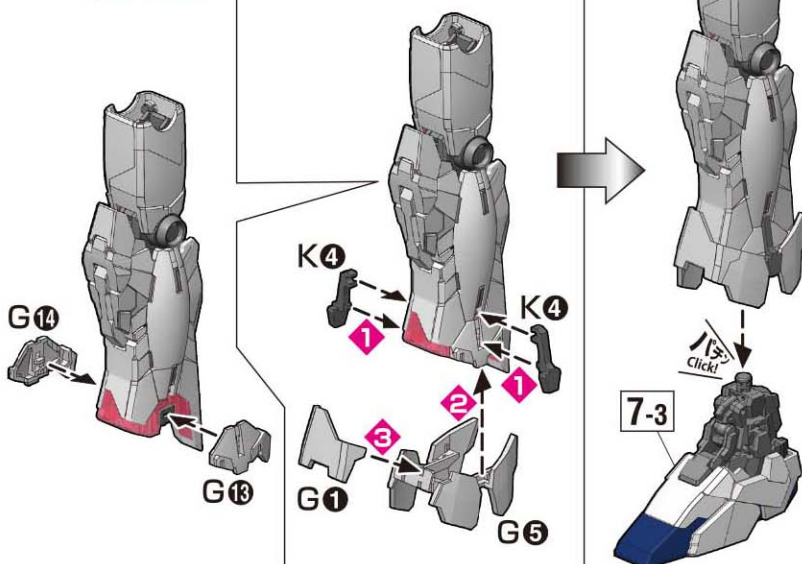

8-1 LEFT LEG

(左脚の組立)

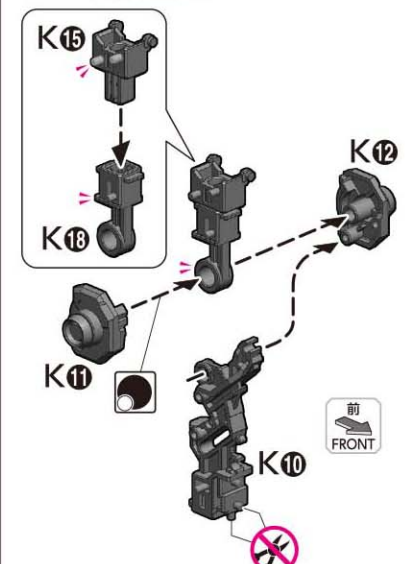

8-2

8-1



向きをかえします。
Turn the part.



向きをかえします。
Turn the part.

(ナラティブガンダム C装備)
(NARRATIVE GUNDAM C-PACKS)

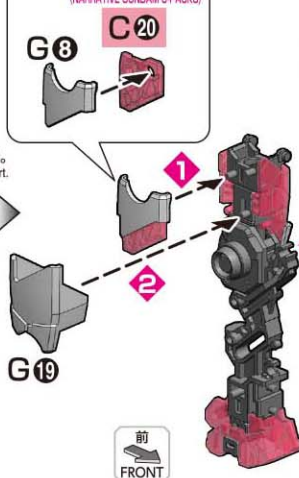

向きをかえします。
Turn the part.

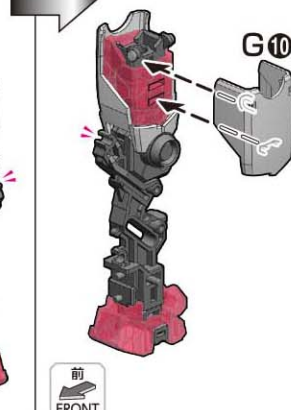

8-3

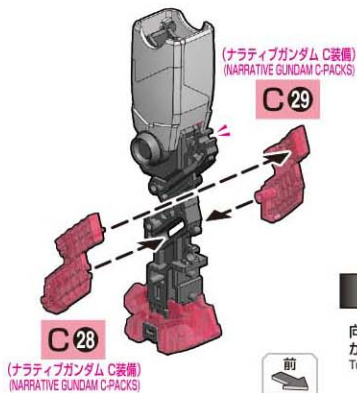

向きをかえします。
Turn the part.



向きをかえします。
Turn the part.

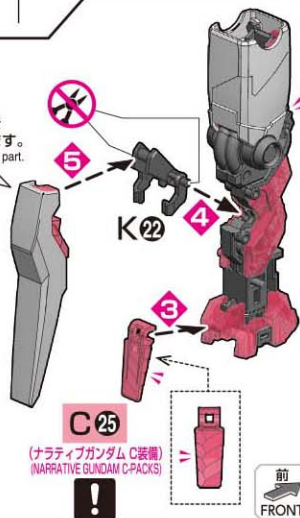

向きをかえします。
Turn the part.

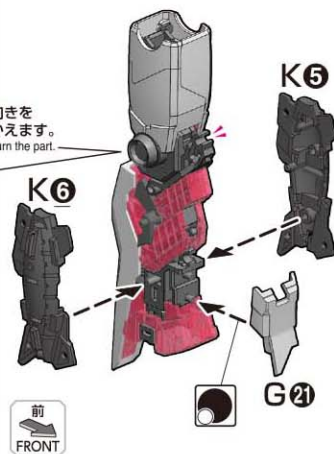

8-4 COMPLETION

(左脚の完成)

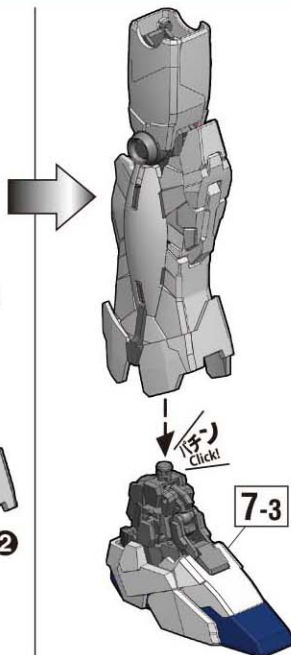
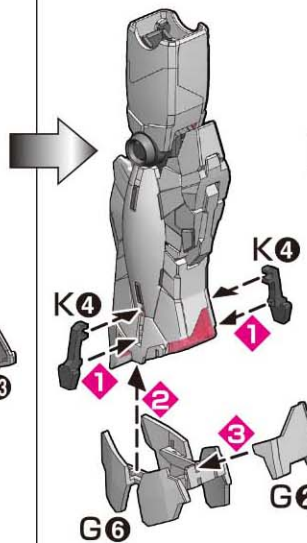
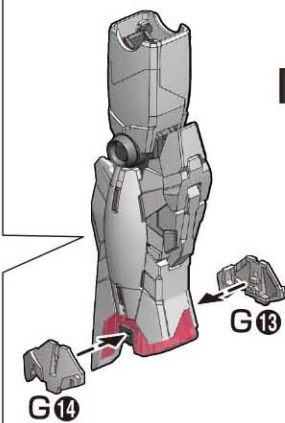
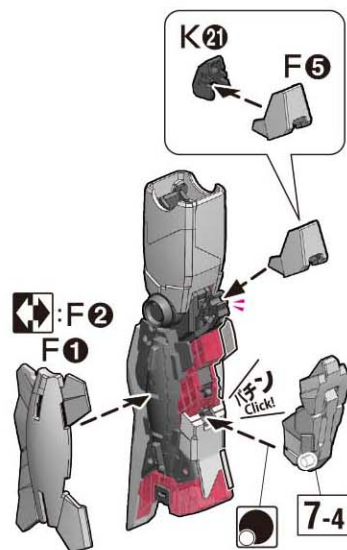



9-1 BACKPACK

〔バックパックの組立〕

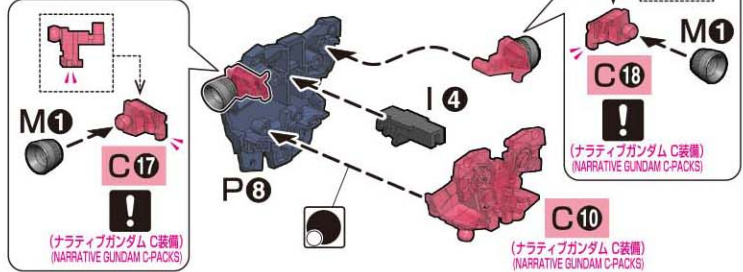

9-2

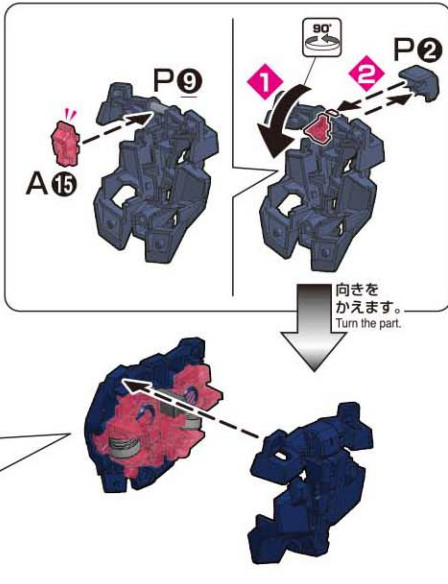
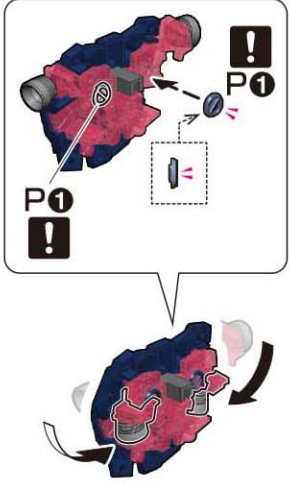

9-3 COMPLETION

〔バックパックの完成〕

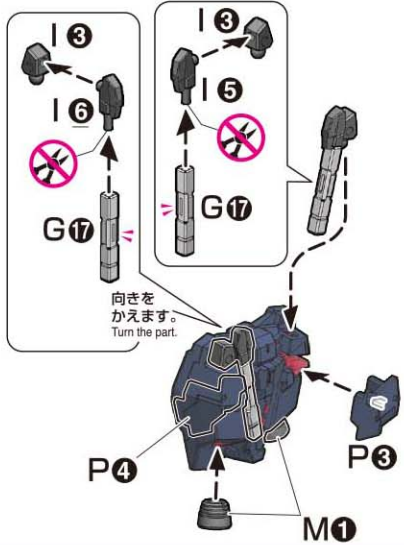

10 LOWER BODY ASSEMBLE

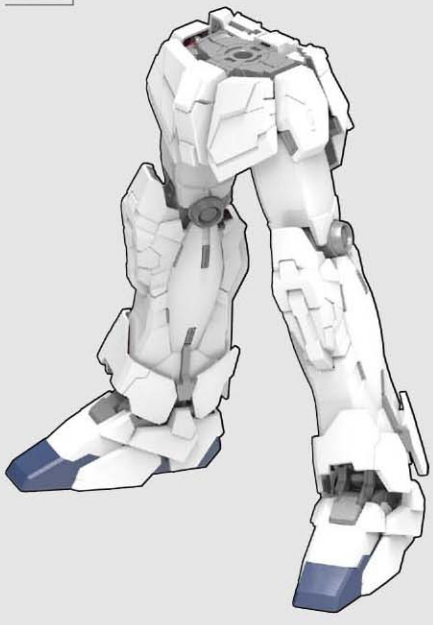

10 LOWER BODY

〔下半身の組立〕

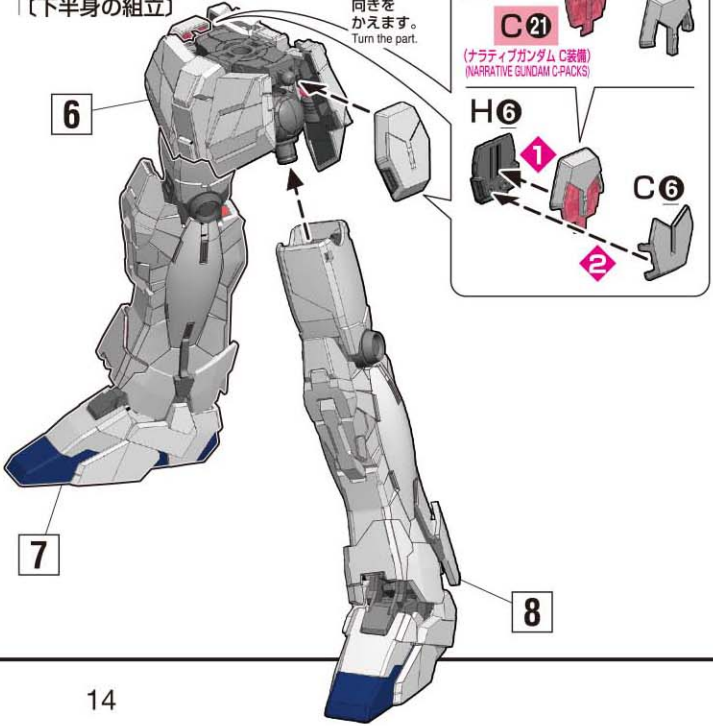

11 BODY ASSEMBLE

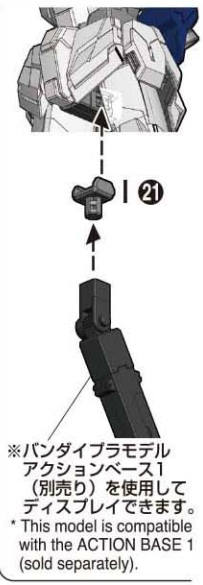
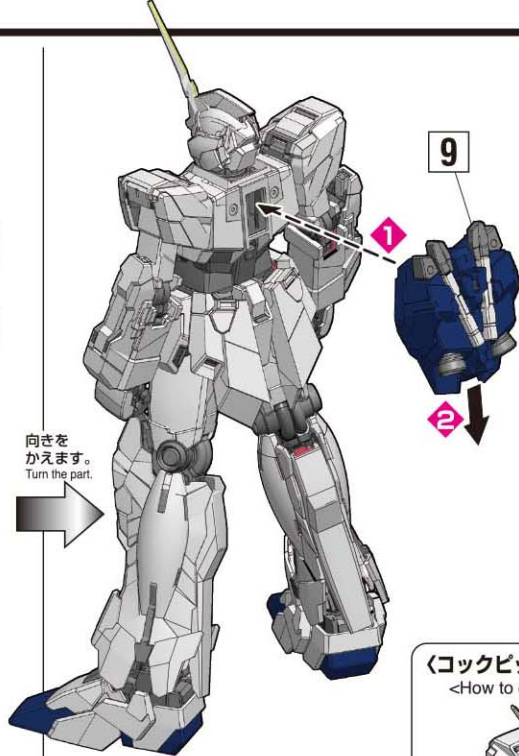
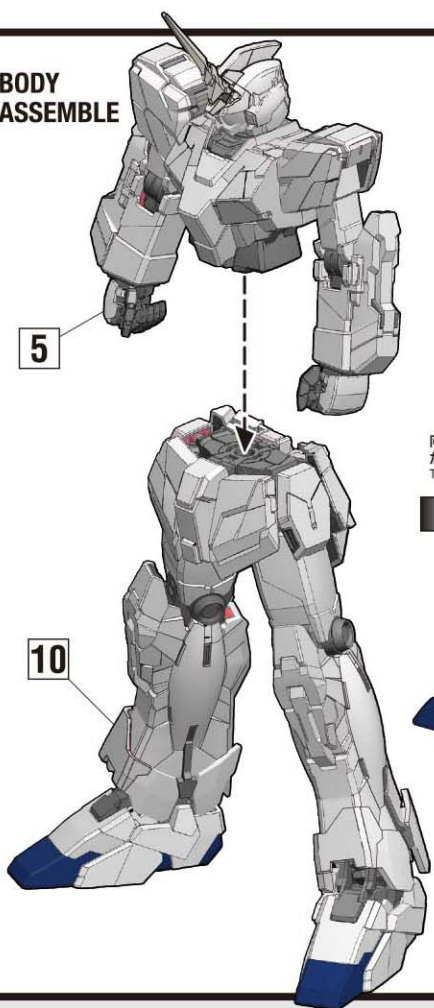

＜コックピット・ハッチの開けかた＞ ＜How to open the cockpit hatch＞

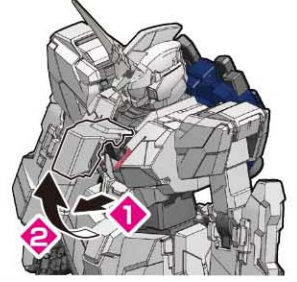

※D6は好きな所に飾ってください。
* Place D6 wherever you prefer.

12 BEAM MAGNUM 13 HYPER BAZOOKA 14 SHIELD

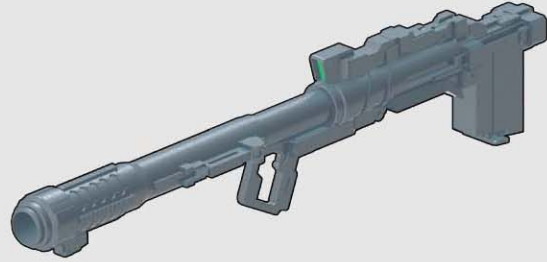

12-1 BEAM MAGNUM 〔ビーム・マグナムの組立〕

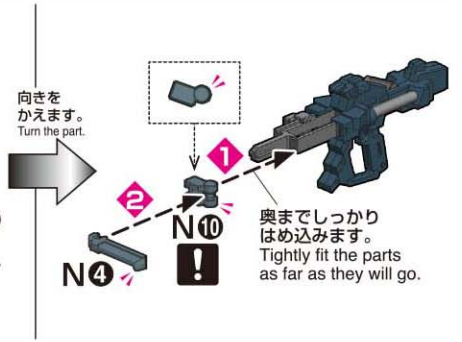
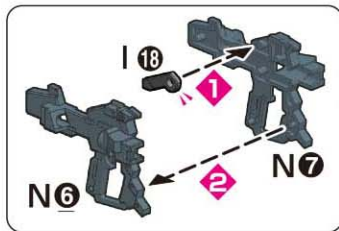

12-2

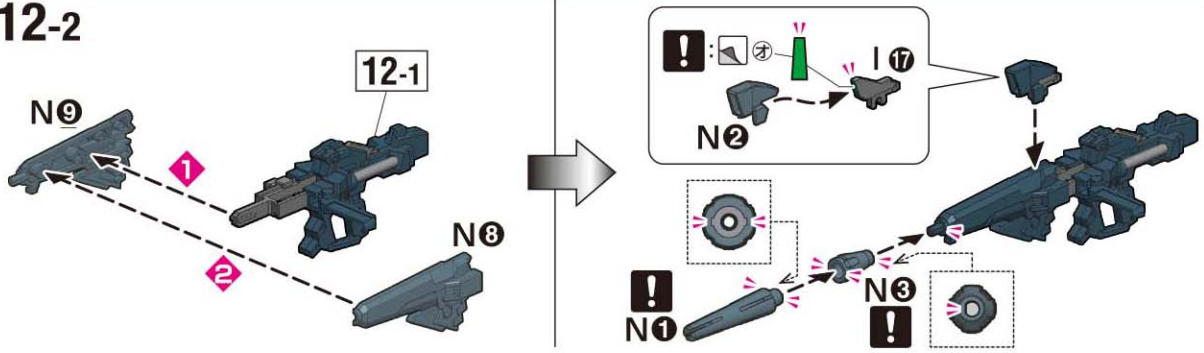

12-3

×3

きれいに
切り取ります。
Cut out cleanly.

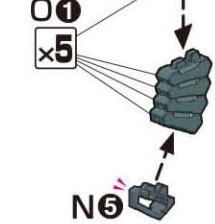

12-4 COMPLETION

〔ビーム・マグナムの完成〕

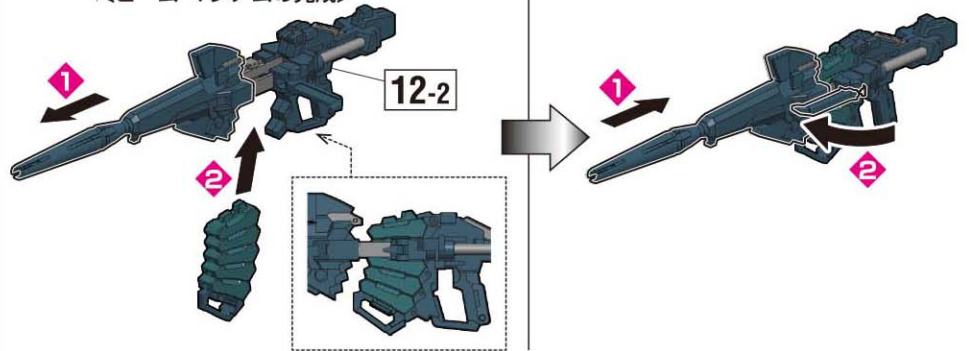

13-1 HYPER BAZOOKA

〔ハイパー・バズーカの組立〕

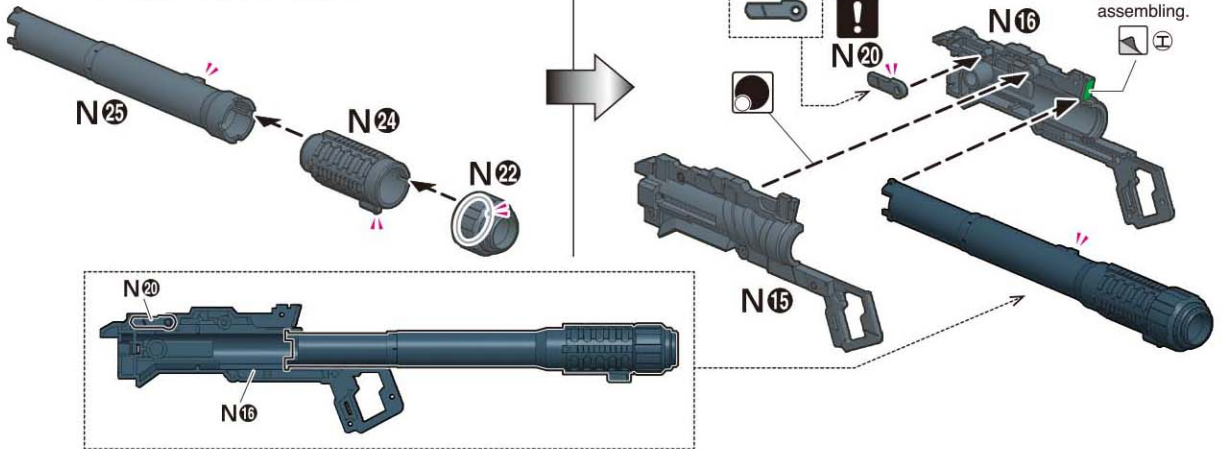

13-2

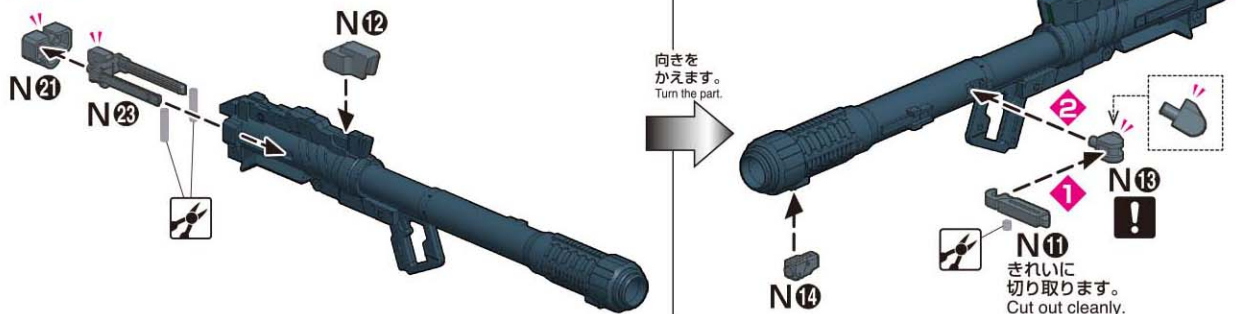

13-3 COMPLETION

(ハイパー・バズーカの完成)



14-1 SHIELD

(シールドの組立)

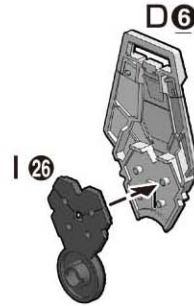

14-2

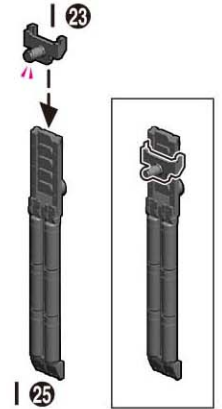

14-3

(ナラティブガンダム C装備)
(NARRATIVE GUNDAM C-PACKS)

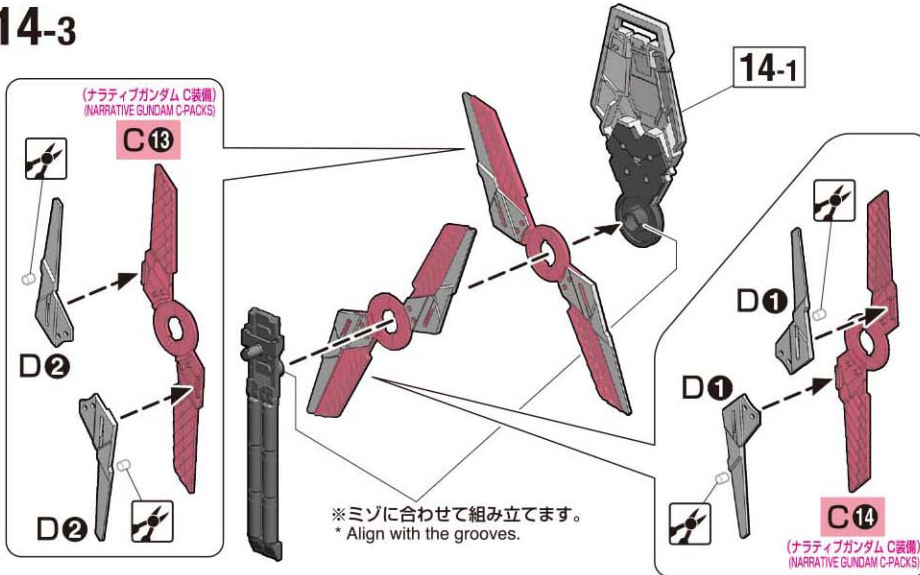

14-4

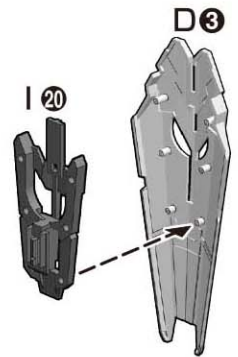

14-5 COMPLETION

(シールドの完成)

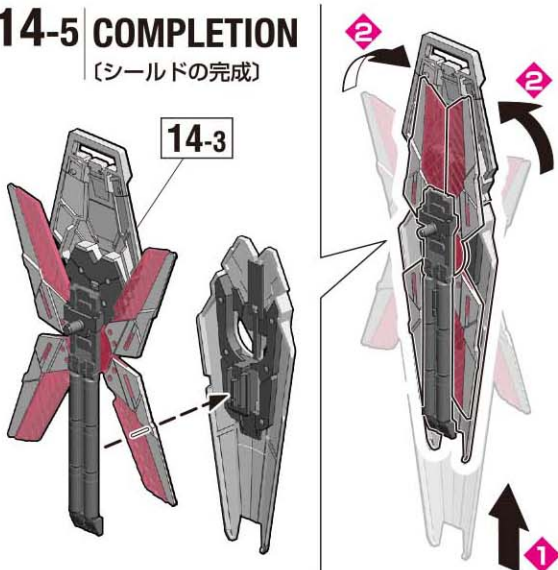

15-1 WEAPONS EQUIPMENT

(武器の装備)

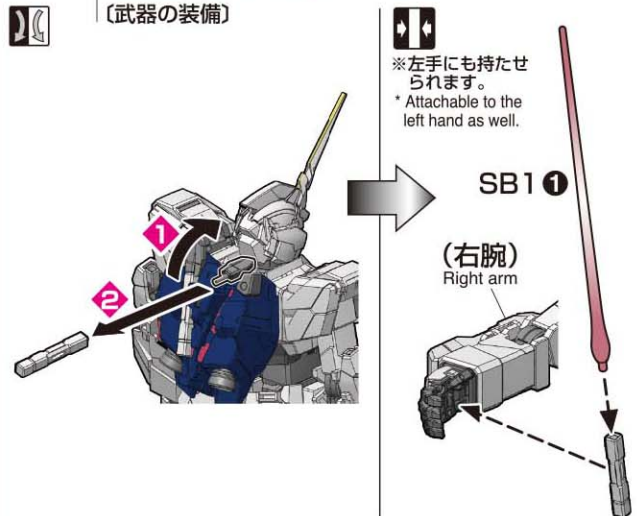

15-2

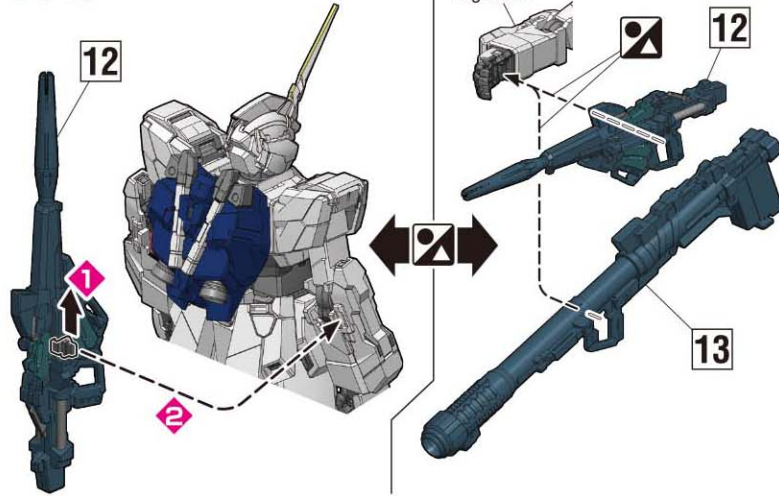

15-3

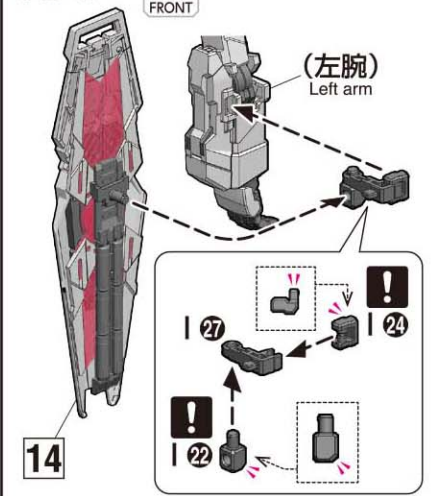

15-4

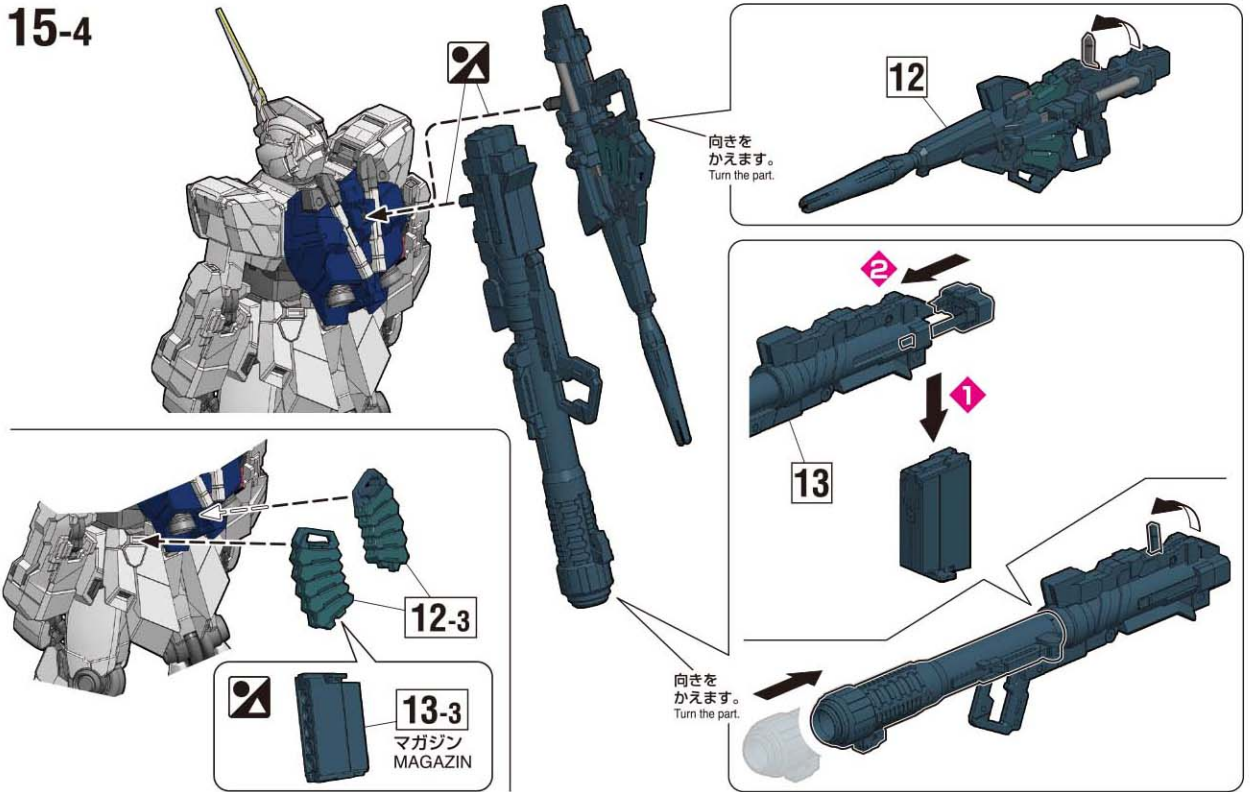

15-5

