

HG

GUNDAM HG 1/144 INDUSTRIAL DESIGN VER.

G440

HG 1/144 GUNDAM G40 (INDUSTRIAL DESIGN VER.)

The various configurations of this product underwent an examination of forms and mechanisms by KEN OKUYAMA DESIGN.



GUNPLA

BANDAI

5058183

BANDAI SPIRITS 2019 MADE IN JAPAN

GUNDAM.INFO Search
www.gundam.info

ガンダム G40 (Industrial Design Ver.) 取扱説明書 (とりあつかいせつめいしょ)

警告 (けいこく)
保護者の方へ 必ずお読みください。
●小部品があります。誤飲・窒息の危険がありますので、3才未満のお子様には絶対に与えないでください。
注意 (ちゅうい)
●緑部が鋭い箇所がありますので、注意してください。
●先端が尖っている箇所がありますので、注意してください。
●部品はきれいに切り取り、切り取ったあとのクズは捨ててください。
●袋を頭からかぶったり、顔を覆ったりしないでください。窒息する恐れがあります。

WARNING
Parents and guardians, read the following instructions before use.
●CHOKING HAZARD - Small parts. Not for children under 3 years.
CAUTION
●Pay attention to sharp parts and edges.
●Pay attention to sharp parts. Be careful when handling.
●Cut the necessary parts from the sprue carefully, and discard the remnants.
●To avoid suffocation, do not put the plastic bag over your face.
(組み立てる時の注意) ●組み立てる前に説明書をよく読みましょう。●部品は番号を確かめ、ニッパーなどできれいに切り取りましょう。●塗装にはより安全な水性塗料のご使用をおすすめします。●尖った先端や薄い縁部に触れながらの組み立てには十分ご注意ください。(Notes on assembly) ●Carefully read the instructions before assembling. ●Check the part number, and cut them cleanly with nippers. ●Use of water-based paint is recommended for safety reasons. ●Pay extra attention when handling sharp points and edges.

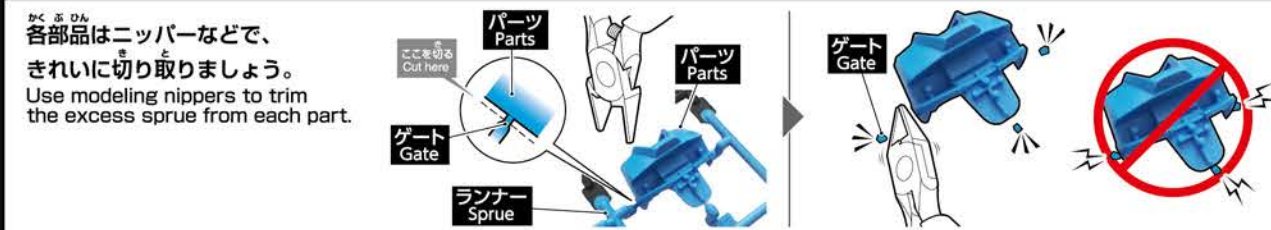

Parts list diagram with categories: A/Parts A Parts (PS), B1/Parts B1 Parts (PS), B2/Parts B2 Parts (PS), C/Parts C Parts (PS) x 2, SB-13/Parts SB-13 Parts (PS), Stickers, and Special art book. Includes notes about clear parts and manufacturing differences.

Assembly manual page 1: 1. 顔部 (HEAD) - Select a part to attach. 2. ボディ (BODY) - Assemble in numerical order. Confirm the direction and shape of the parts. Build specified number of parts. Do not cut. Do not cut here. Use identical part / section for each side. Move the opposite side as well. Cut here.

※部品の向きや左右など、イラストをよく見て組み立ててください。※形状が似ているパーツがありますので番号を確認し、順番に組み立ててください。Refer to the illustrations and pay attention to parts orientation/direction during assembly. Some parts may be difficult to distinguish from one another. Check the part numbers and follow the assembly order.

Assembly manual page 2: 1. 顔部 (HEAD) - Select a part to attach. 2. ボディ (BODY) - Assemble in numerical order. Confirm the direction and shape of the parts. Build specified number of parts. Do not cut. Do not cut here. Use identical part / section for each side. Move the opposite side as well. Cut here.

Assembly manual page 3: 3. バックパック (BACK PACK) - Build two sets. Do not cut. 4. 右腕 (RIGHT ARM) - Select a part to attach. Build two sets. Do not cut. Do not cut here. Use identical part / section for each side. Move the opposite side as well. Cut here.

※画像と商品とは、多少異なりますのでご了承ください。
※画像はイメージです。
※実際の商品とは、多少異なります。
※この商品はHG 1/144 ガンダム G40 (Industrial Design Ver.) が1セット入っています。
※The actual product may vary slightly from the images.
※The images are for illustrative purposes only.
※This package contains one set of HG 1/144 GUNDAM G40 (Industrial Design Ver.).

5 (左腕 LEFT ARM)

ひびきで
(左腕 LEFT ARM)

C1, C2, C3, C4, C5, C6, C7, C8, C9, C10, C11, C12

手首D
WRIST D

手首E
WRIST E

(通んで取り付ける)
Select a part to attach.

6 (足 FEET)

(2組作る)
Build two sets.

(足 FEET)

A26, A27, A28, A29, A30, A31, A32, A33, A34, A35, A36

A37, A38, A39, A40, A41, A42, A43, A44, A45, A46, A47

7 (右脚 RIGHT LEG)

B12, B13, B14, B15, B16, B17, B18

C13, C14, C15, C16, C17, C18, C19

C20, C21, C22, C23, C24, C25, C26

向きをかえます。
Turn the part.

A37, A38, A39, A40, A41, A42, A43

B19, B20, B21, B22, B23, B24, B25

C27, C28, C29, C30, C31, C32, C33

8 (左脚 LEFT LEG)

B19, B20, B21, B22, B23, B24, B25

C13, C14, C15, C16, C17, C18, C19

C20, C21, C22, C23, C24, C25, C26

向きをかえます。
Turn the part.

A37, A38, A39, A40, A41, A42, A43

B19, B20, B21, B22, B23, B24, B25

C27, C28, C29, C30, C31, C32, C33

9 (腰部 WAIST)

B10, B11, B12, B13, B14, B15, B16

C6, C7, C8, C9, C10, C11, C12

(後から組む)
Assemble this part later.

10

A4, A5, A6, A7, A8, A9, A10

B17, B18, B19, B20, B21, B22, B23

手首を分解し取り付けます。
*Take the wrist apart and attach it.

手首B
WRIST B

A37, A38, A39, A40, A41, A42, A43

*奥までしっかりとめ込みます。
*Tightly fit the parts as far as they will go.

11 (武器 WEAPONS)

A9, A10, A11, A12, A13, A14, A15, A16

A19, A20, A21, A22, A23, A24, A25

(切り取り注意)
Do not cut.

切り取ります
Cut here.

SB-13
左手にも持たせられます。
Attachable to the left hand as well.

A44, A45, A46, A47, A48, A49, A50

手首D
WRIST D

(通んで取り付ける)
Select a part to attach.

*手首を分解し
取り付けます。
*Take the wrist
apart and
attach it.

A51, A52, A53, A54, A55, A56, A57

A58, A59, A60, A61, A62, A63, A64

*奥までしっかりとめ込みます。
*Tightly fit the parts as far as they will go.

A65, A66, A67, A68, A69, A70, A71

*バンダイプラモデル
アクションベース5
(別売り)股間止め用
ACB-5,または
はさみ込み用に対応
しています。
*Compatible with
ACB-5 or pinching
connector for
the ACTION BASE 5
(sold separately)

*画像の完成品は塗装してあります。
*The completed product in the image
has been painted.